

Thickness Gauge Probe

Ordering Information:



TG2-12L

Series Code | Connector Type
Frequency | Crystal dimension $\Phi 12$

Application:

Mainly used for measuring work piece thickness.

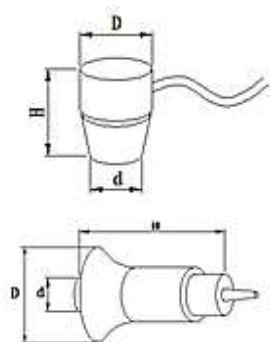

Twin crystal (H for High temperature)

Series Code	Crystal Size (mm)	D	d	H
TG	$\Phi 6$	$\Phi 14.5$	$\Phi 9.5$	27.5
	$\Phi 8/\Phi 10$	$\Phi 18$	$\Phi 11.5$	27.5
	$\Phi 12$	$\Phi 22.8$	$\Phi 16.3$	26.5

Series Code	Crystal Size (mm)	D	d	H
TG	$\Phi 10(H)$	$\Phi 42$	$\Phi 11.7$	67

Series Code	Frequency (MHz)	Crystal Size (mm)	Connector Type
TG	2	$\Phi 12$	L: LEMO 00/ MD: Microdot
	5	$\Phi 6, \Phi 8, \Phi 10$	
		$\Phi 10 (H)$	
7.5	$\Phi 6$		

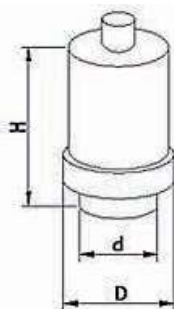

Single crystal (N for normal probe, which also be used for flaw detectors)

Series Code	Crystal Size (mm)	D	d	H
TGM	$\Phi 20(N)$	$\Phi 28$	$\Phi 26$	45

Series Code	Frequency (MHz)	Crystal Size (mm)	Connector Type
TGM	1/ 2.5	$\Phi 20(N)$	Blank: BNC/ L: LEMO 00/ MD: Microdot

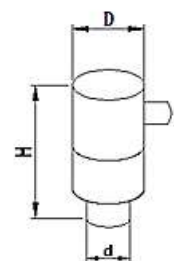

Single crystal (D for delay line probe, wide frequency series)

Series Code	Crystal Size (mm)	D	d	H
TGM	$\Phi 3(D)$	$\Phi 12$	$\Phi 4$	26
	$\Phi 6(D)$	$\Phi 14.5$	$\Phi 8$	28.8

Series Code	Frequency (MHz)	Crystal Size (mm)	Connector Type
TGM	5	$\Phi 6(D)$	L: LEMO 00/ MD: Microdot
		$\Phi 3(D)$	MD: Microdot
	7.5/10	$\Phi 6(D)$	L: LEMO 00/ MD: Microdot

*All twin crystal TG probes are with cable.